

尺寸:90*60mm

材质:

MIG VAPOR

MANUAL



SUB 40

Thank you for purchasing our SUB 40 Battery, to ensure you make most of it, please read user manual carefully before using it

Kit contains

- 1*SUB 40 Battery
- 1*USB Cable
- 1*User Manual
- 1*Notice Card
- 1*Quality Certificate

Product Introduction

Metal material, graceful and good looking
Real 40W wattage output, mini body, huge power
With clear screen, easy to use and handle
Multiple protections design to ensure security during using
Ergonomic design provides a good sense of comfort
Section design--totally considerable for users

Product Parameters

Size: 81*22*32mm
Resistance: 0.3Ω
Voltage: 3.3V-4.2V
Wattage: 7-40W
Battery capacity: 2200mAh

Product Structure

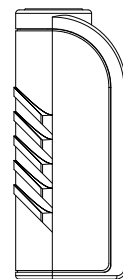

Battery device

Quick Use

Power On/ Off

1. Press the power button 5 times within 2 seconds to turn on the device, the screen shows "HELLO ECT" and it enters main interface of wattage mode with parameters of battery condition, resistance, voltage and wattage on.
2. Press the power button 5 times within 2 seconds to turn off the device

Vape with no load

When vaping without tank, output shut off, it flashes with "9.99Ω" as a warning

Wattage Adjustment

Under main interface, Wattage is adjustable from 7-40w by pressing "+" or "-"

Condition of Vaping

The screen shows battery condition, resistance, voltage and wattage when vaping

Condition of Vaping Ready

Under the Condition of "vaping ready", the screen shows the content of main interface and vaping is allowed anytime

Sleeping Mode

screen shuts off with 10S no operation, and it enters sleeping mode. Press any button to awake the device then vape

Charging

1. Battery condition icon will be shown on the screen during charging to display charging process
2. After fully charged, the battery condition icon stops flashing

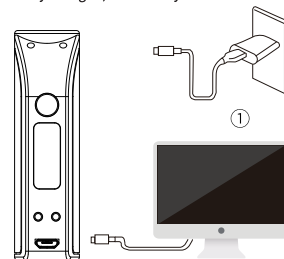

Device Protections

Low voltage warning:

When the battery voltage is lower than 3.3v, "Low Battery" is shown on the screen and output shut off, meanwhile the battery condition icon flashes. Warning will be removed when voltage goes back to normal

short-circuit protection:

When the coil suffers short-circuit condition, the device stops output and screen flashes "9.99Ω" as a warning

Kindly remind

The condensation phenomena happens when high-temperature vapor meets low or normal-temperature in wall of the atomizer.
E-liquid is fast moving consumer goods. Plz refill it in time when it's insufficient to avoid dry heating.
Clean the inside of the atomizer when refilling to avoid flavor mix.
Do not use on people who are under 18, pregnant, breast-feeding and people with heart disease, respirator disease other disease.
If any discomfort, please stop using it.

www.migvapor.com

4100 North Powerline Road
Suite A5 Pompano Beach, FL 33067



Designed in Miami
Made in China with Passion



MIG VAPOR